



Indoor Current Transformer

Model JAB-0CV 600V, 10kV BIL, 200-3000A

Window Size 4.50" X 3.50"

For High Ambient Temperature Applications



APPLICATION

Designed for indoor service; especially designed for installation over the secondary bushings of pad mounted transformers from 75 kVA to 3000 kVA.

This special version of the JAB-0CV current transformer is designed for use on heavily loaded pad mount transformers operating in high temperature environments up to 85° C. For mounting and application information, including use at higher voltages, and matching the current rating to the pad transformer thermal capability, please refer to the Applications Information section of catalog GEP-9186.

WEIGHT

Approximately8.25 lbs

REFERENCE DRAWINGS

Outline0121C33851

INSULATION LEVEL

0.6kV; BIL 10kV full wave

FREQUENCY

50-60 Hz

JAB-0CV DATA TABLE

Current Ratio (Amps) Pri : Sec	ANSI Accuracy Class, 60 Hz Burden Per ANSI					Continuous Thermal Current Rating Factor @ 85° C Amb.	Catalog Number (With Secondary Hardware and Cover)
	BO.1	BO.2	BO.5	BO.9	B1.8		
200:5	0.3	--	--	--	--	4.0	750X236202
300:5	0.3	0.3	--	--	--	4.0	750X236203
400:5	0.3	0.3	--	--	--	4.0	750X236204
500:5	0.3	0.3	0.3	--	--	3.0	750X236205
600:5	0.3	0.3	0.3	--	--	3.0	750X236206
800:5	0.3	0.3	0.3	--	--	3.0	750X236208
1000:5	0.3	0.3	0.3	--	--	2.0	750X236210
1200:5	0.3	0.3	0.3	--	--	2.0	750X236212
1500:5	0.3	0.3	0.3	0.3	--	2.0	750X236215
2000:5	0.3	0.3	0.3	0.3	0.3	1.5	750X236220
3000:5	0.3	0.3	0.3	0.3	0.3	1.33	750X236230

Notes:
Consult factory for base plate provisions.

Construction and Insulation

The core and coil assembly is enclosed within a molded case. The case is molded with a thermoplastic PET resin. This tough material has excellent electrical and mechanical properties over a wide temperature range, has low water absorption and is resistant to oil and a variety of chemicals.

Core and Coils

The core is made from high quality grain oriented silicon steel, annealed under rigidly controlled factory conditions. The copper wire used in the secondary winding is coated with high temperature enamel rated for operation at 200° C. The secondary windings are evenly distributed around the core for maximum accuracy and resistance to stray fields from adjacent conductors.

Terminals

Secondary terminals are tin plated brass, compression type with a 0.275" diameter cross-hole for wiring and a 1/4-28 clamp screw. A shorting device is provided and interlocked to the terminal cover. The terminal cover is made of a clear plastic. Provision is made for sealing the cover.

Polarity

Primary and secondary marks H1, H2 and X1, X2 are molded into the case. In addition, H1 and X1 are identified by white dots.

Primary Conductor

These transformers are primarily intended for installation over the bushing and terminal blade of pad mount transformers, which then forms the primary conductor.

Nameplates

The nameplate is laser engraved aluminum. It is attached to the top of the unit and has provision for attaching the user's identifying tag. The nominal current rating is on both faces of the unit in large numerals.

Mounting

The transformer can be mounted in any position but is usually installed on the pad mount transformer terminal blade using the Valox "grabbers". The grabbers are removable and the transformer also has two mounting holes allowing it to be attached to a mounting bracket.

Maintenance

These transformers require no maintenance, other than occasional cleaning, if installed where air contamination is severe.

Data subject to change without notice

To purchase or obtain more information about GE Instrument Transformer products, please call GE Multilin at 1-800-547-8629. Product information is also available on our web site at <http://www.GEMultilin.com>. Click on the Product Index button (right column), select Transformers and follow the menus to **Product Information** or a **Solutions Advisor**.

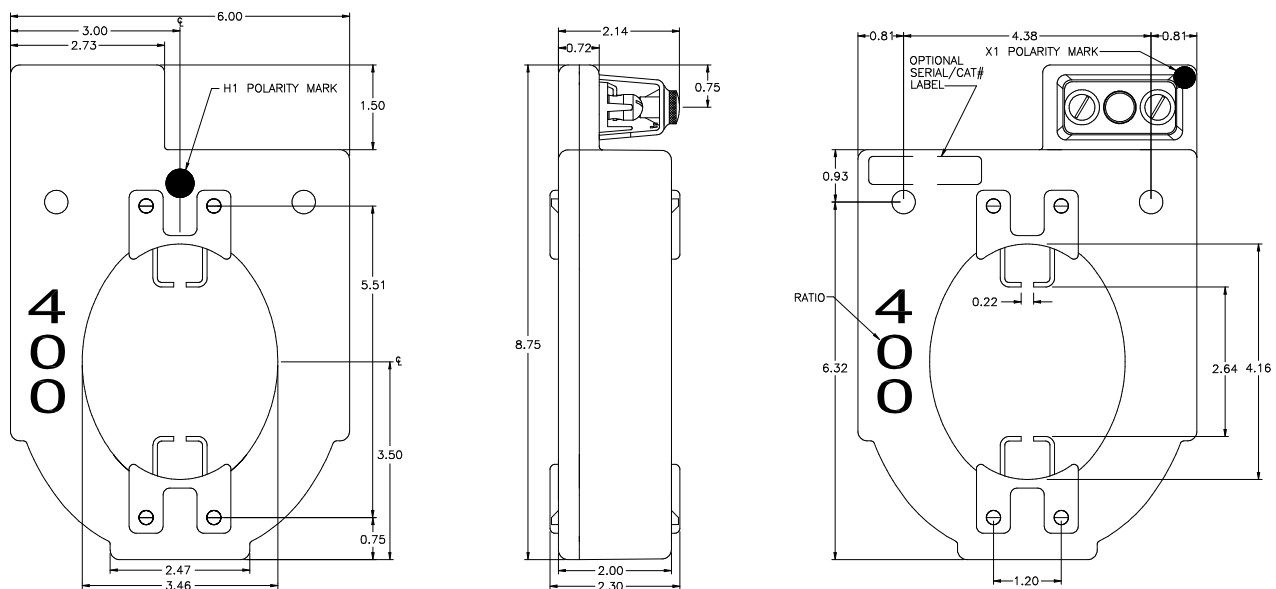

JAB-OCV Dimensions

USA, Canada, Asia, Latin America

Tel: +1-800-547-8629

Fax: +1-905-201-2455

e-mail: sales.multilin@ge.com

Europe, Middle East, Africa

Tel: +34-94-485-88-00

Fax: +34-94-485-88-45

e-mail: gmultilin.euro@ge.com